

G Series General Purpose Battery

G-12750 (12V70AH) Gel Sealed Lead Acid

Specifications

Nominal Voltage	12V
Nominal Capacity	70 AH/3.50A (20 hr. to 1.80V/cell @ 77°F/25°C) 64 AH/6.38A (10 hr. to 1.80V/cell @ 77°F/25°C) 61 AH/7.65A (8 hr. to 1.75V/cell @ 77°F/25°C)
Length	10.2 in. (259±3mm)
Width	6.61 in. (168±2mm)
Total Height (with Terminal)	8.43 in. (214±3mm)
Approx. Weight	Approx. 50.7 lb. (23.0kg)
Hardware / Torque Rating	M6 / 35-48 in. lb.
Container Material	ABS
Max. Discharge Current	700A (5s)
Internal Resistance	Approx. 7.9mΩ
Operating Temp. Range	Discharge: -4° to 131°F (-20° to 55°C) Charge: 32° to 104°F (0° to 40°C) Storage: -4° to 122°F (-20° to 50°C)
Nominal Operating Temp.	77±5°F (25±3°C)
Cycle Use	Initial Charging Current less than 17.5A Voltage 14.4V to 15.0V at 77°F (25°C) Temp. Coefficient -30mV/°C
Stand by Use	Float Voltage: 13.5V at 77°F (25°C) Equalize Voltage: 14.1V at 77°F (25°C)
Capacity Affected by Temperature	104°F (40°C) 103% 77°F (25°C) 100% 32°F (0°C) 86%
Self Discharge	SBS S Series batteries may be stored for up to 6 months at 77°F (25°C) and then a freshening charge is required. For higher temperatures the time interval will be shorter.



Applications

- Telecommunications
- Utility
- Industrial
- Deep cycle
- All purpose



G-12750 (12V70AH)

Constant Current Discharge (Amperes) at 77°F (25°C)

F.V/Time	20 min	30 min	45 min	1 hr	2 hr	3 hr	4 hr	5 hr	6 hr	7 hr	8 hr	9 hr	10 hr	20 hr
1.85V/cell	59.2	46.5	35.5	29.7	18.8	14.4	11.9	10.3	8.86	7.84	7.07	6.46	6.11	3.36
1.80V/cell	67.8	51.9	39.1	32.8	20.4	15.4	12.6	10.8	9.30	8.21	7.41	6.80	6.38	3.50
1.75V/cell	76.2	57.1	42.3	35.1	21.6	16.2	13.2	11.2	9.63	8.50	7.65	7.00	6.51	3.57
1.70V/cell	82.1	61.2	44.9	37.1	22.9	16.9	13.6	11.6	9.96	8.78	7.88	7.19	6.66	3.62
1.67V/cell	85.5	63.6	46.5	38.5	23.5	17.5	14.0	11.8	10.1	8.91	8.00	7.28	6.74	3.65
1.60V/cell	92.6	68.0	49.9	40.9	24.4	18.2	14.5	12.2	10.4	9.10	8.14	7.44	6.87	3.70

Constant Power Discharge (Watts/cell) at 77°F (25°C)

F.V/Time	20 min	30 min	45 min	1 hr	2 hr	3 hr	4 hr	5 hr	6 hr	7 hr	8 hr	9 hr	10 hr	20 hr
1.85V/cell	113.3	89.6	68.8	57.8	36.8	28.1	23.4	20.3	17.5	15.6	14.1	12.9	12.2	6.71
1.80V/cell	128.1	99.2	75.3	63.5	39.6	30.0	24.7	21.2	18.4	16.2	14.7	13.5	12.7	6.98
1.75V/cell	142.4	108.0	80.8	67.6	41.9	31.6	25.8	22.0	19.0	16.8	15.1	13.9	12.9	7.11
1.70V/cell	151.7	114.7	85.2	71.1	44.2	32.9	26.6	22.6	19.6	17.3	15.6	14.3	13.2	7.19
1.67V/cell	156.2	117.9	87.6	73.3	45.1	33.8	27.1	23.0	19.8	17.5	15.8	14.4	13.4	7.25
1.60V/cell	167.3	125.1	93.4	77.5	46.7	34.9	28.1	23.6	20.2	17.8	16.0	14.7	13.6	7.35

Dimensions

T6 Terminal

Unit: mm [inches]

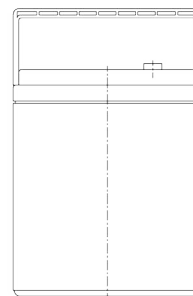
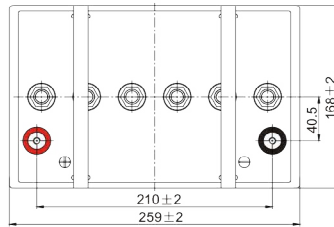
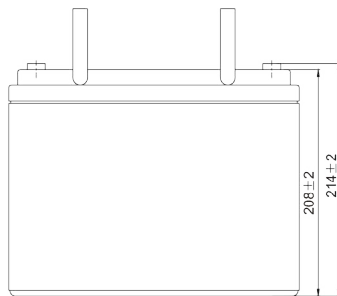
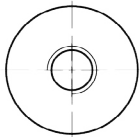
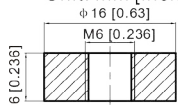

Discharge Characteristics

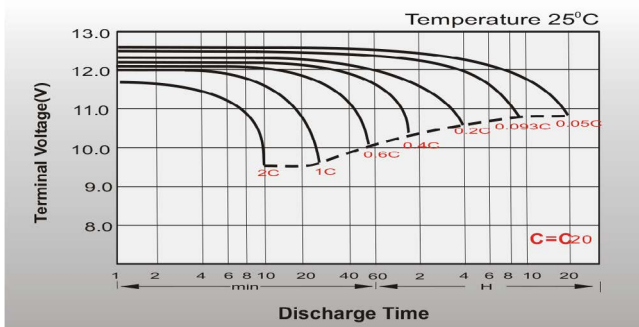

Float Charging Characteristics

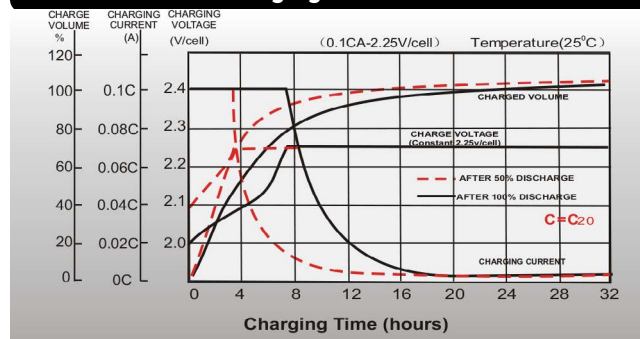

Temperature Effects in Relation to Battery Capacity

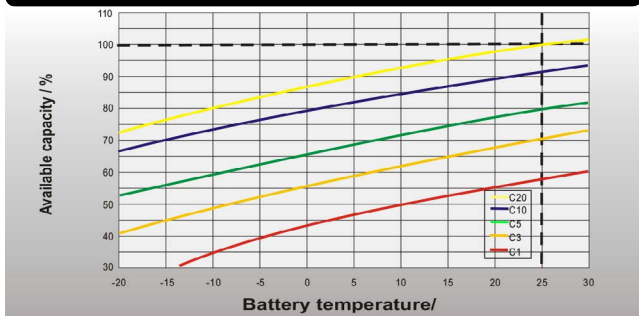

Effect of Temperature on Long Term Float Life

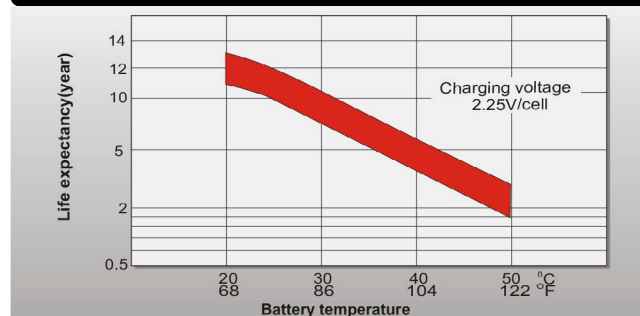

Cycle Life in Relation to Depth of Discharge

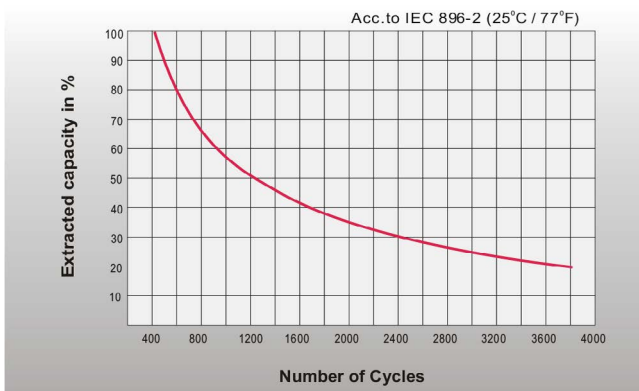

General Relation of Capacity VS. Storage Time

